

ALLPROOF INDUSTRIES SLIMLINE ARCHITECTURAL CHANNEL SYSTEM TIMBER FLOOR WITH WALL INSTALL

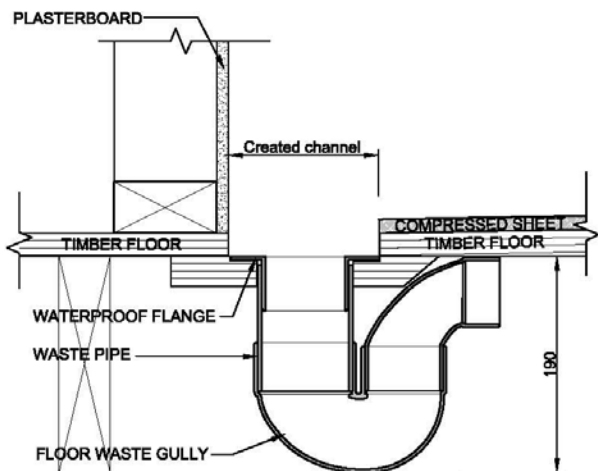

Step One

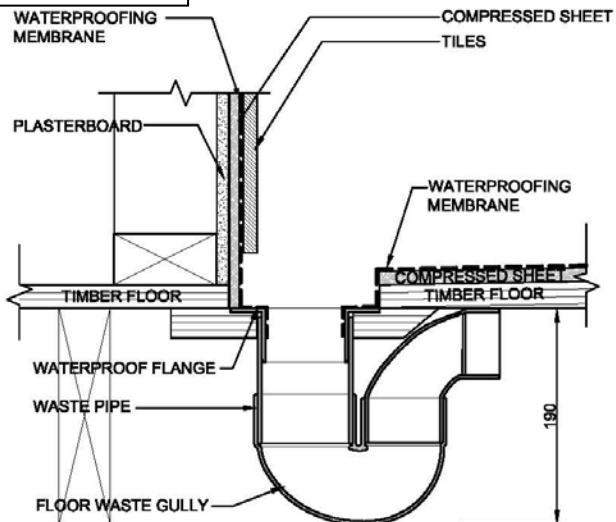

Step Two

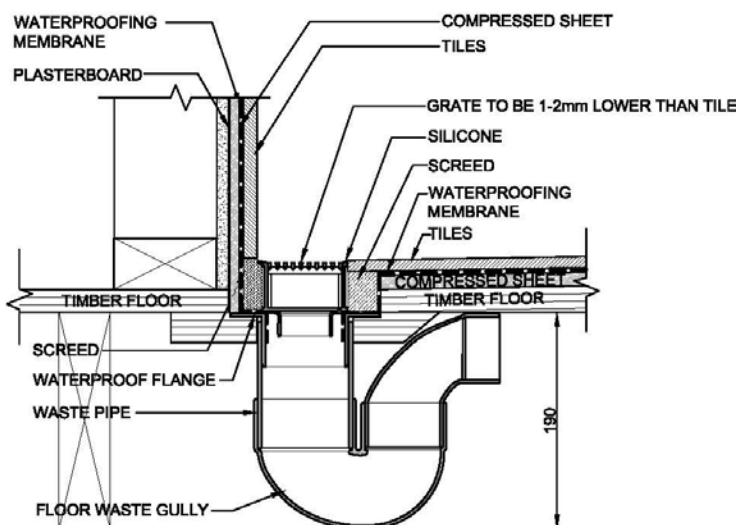

Step Three

For 38mm and 65mm channels, the created channel should be made 100mm wide and at a minimum depth of 35mm.

For 100mm channels, the created channel should be made 135mm wide and at a minimum depth of 10mm.